

Revised - 01/04/2023  
APPROVED UNDER CONVEYANCE  
CERTIFICATE NO. C-100/2/23  
MAHARASHTRA  
(B.P.S. Zone 9) P.M.C.

PROPOSED LAYOUT PLAN AT S.NO. 17,  
H.NO. 10/11A OF MAJEE, KONDHWA (H)  
TAL-HAVELI DIST. PUNE

Drawing Sheet  
No-01/12

LAYOUT  
ENVIRONMENTAL CLEARANCE NO. -EC230308MH11092  
21.07.2023  
STAMPS OF APPROVAL OF PLANS:-



AREA STATEMENT

01	AREA OF PLOT (MIN AREA OF A.B.C. TO BE CONS.)	13200.00
A	AS PER D.O. (715 CTS EXTRACT)	7300
B	AS PER MEASUREMENT SHEET REG. AGG. AREA	13111.20
C	AS PER SITE	13200.00
D2	DEDUCTIONS FOR	
A	PROPOSED 24.00 M D.P. ROAD WIDENING AREA	227.81
B	EXISTING ROAD 6.00 M WIDE	163.31
C	EXISTING ROAD 12.00 M WIDE	365.07
D	ANY D.P. RESERVATION AREA	38.39
E	ANY RESERVATION (NALA)	634.58
F	TOTAL (A+B+C+D+E)	1436.42
G	AMENITY SPACE (IF APPLICABLE)	0.00
H	ADJUSTMENT OF (A+B+C+D+E)	1531.20
I	OPEN SPACE	1436.42
J	AMENITY SPACE	0.00
K	RECREATIONAL OPEN SPACE (IF APPLICABLE)	0.00
L	AS REQUIRED	1436.42
M	PROPOSED	1436.42
N	INTERNAL ROAD AREA	12928.88
O	PLOT AREA (APPLICABLE)	14221.77
P	BUILDUP AREA WITH REFERENCE TO BASE F.S.I. As Per Form With Ref. No. 10/11A (B) AND/OR C. By 1st under development by P.O. H. 10/11A (B) & C. By 2nd under development by P.O. H. 10/11A (B) & C.	9454.99
Q	AREA FOR LIG MUGS	2844.35
R	TOTAL (O+P+Q)	4768.78

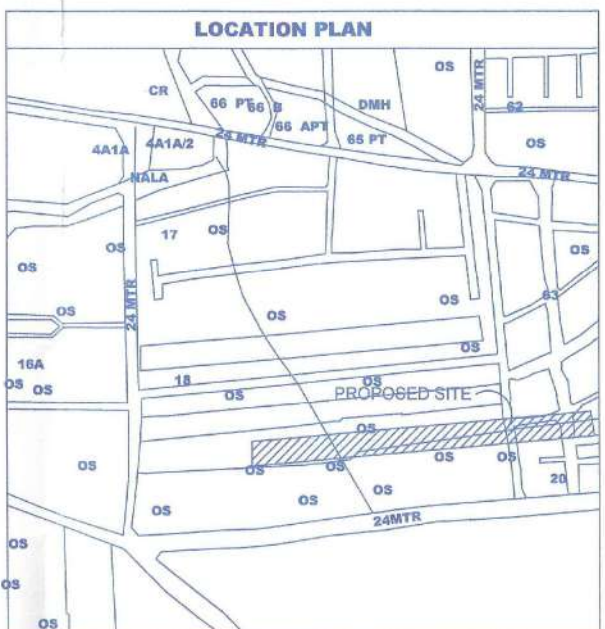

F.S.I. AREA STATEMENT FOR MHADA SQM

BLDG	FLOOR	FLOOR NO.	FLOOR AREA	FLOOR NOS.	FLOOR NOS.
BLDG-A (WING-A1)	FIRST	328.70	102 TO 103	05	
	SECOND	328.70	201 TO 208	05	
	THIRD	328.70	301 TO 308	05	
	FOURTH	328.70	401 TO 408	05	
	FIFTH	328.70	501 TO 508	05	
	SIXTH	328.70	601 TO 608	05	
	SEVENTH	328.70	701 TO 708	05	
	EIGHTH	291.25	801 TO 804	04	
	NINTH	252.17	901 TO 904	04	
	TOTAL	2844.35		43	

TYPE	CAPITAREA	FLOOR	FLOOR NO.	FLOOR AREA	FLOOR NOS.
RESIDENTIAL	0.00	01	01	0.00	01
RESIDENTIAL	0.00	02	02	0.00	02
RESIDENTIAL	0.00	03	03	0.00	03
RESIDENTIAL	0.00	04	04	0.00	04
RESIDENTIAL	0.00	05	05	0.00	05
RESIDENTIAL	0.00	06	06	0.00	06
RESIDENTIAL	0.00	07	07	0.00	07
RESIDENTIAL	0.00	08	08	0.00	08
RESIDENTIAL	0.00	09	09	0.00	09
RESIDENTIAL	0.00	10	10	0.00	10
RESIDENTIAL	0.00	11	11	0.00	11
RESIDENTIAL	0.00	12	12	0.00	12
RESIDENTIAL	0.00	13	13	0.00	13
RESIDENTIAL	0.00	14	14	0.00	14
RESIDENTIAL	0.00	15	15	0.00	15
RESIDENTIAL	0.00	16	16	0.00	16
RESIDENTIAL	0.00	17	17	0.00	17
RESIDENTIAL	0.00	18	18	0.00	18
RESIDENTIAL	0.00	19	19	0.00	19
RESIDENTIAL	0.00	20	20	0.00	20
RESIDENTIAL	0.00	21	21	0.00	21
RESIDENTIAL	0.00	22	22	0.00	22
RESIDENTIAL	0.00	23	23	0.00	23
RESIDENTIAL	0.00	24	24	0.00	24
RESIDENTIAL	0.00	25	25	0.00	25
RESIDENTIAL	0.00	26	26	0.00	26
RESIDENTIAL	0.00	27	27	0.00	27
RESIDENTIAL	0.00	28	28	0.00	28
RESIDENTIAL	0.00	29	29	0.00	29
RESIDENTIAL	0.00	30	30	0.00	30
RESIDENTIAL	0.00	31	31	0.00	31
RESIDENTIAL	0.00	32	32	0.00	32
RESIDENTIAL	0.00	33	33	0.00	33
RESIDENTIAL	0.00	34	34	0.00	34
RESIDENTIAL	0.00	35	35	0.00	35
RESIDENTIAL	0.00	36	36	0.00	36
RESIDENTIAL	0.00	37	37	0.00	37
RESIDENTIAL	0.00	38	38	0.00	38
RESIDENTIAL	0.00	39	39	0.00	39
RESIDENTIAL	0.00	40	40	0.00	40
RESIDENTIAL	0.00	41	41	0.00	41
RESIDENTIAL	0.00	42	42	0.00	42
RESIDENTIAL	0.00	43	43	0.00	43
RESIDENTIAL	0.00	44	44	0.00	44
RESIDENTIAL	0.00	45	45	0.00	45
RESIDENTIAL	0.00	46	46	0.00	46
RESIDENTIAL	0.00	47	47	0.00	47
RESIDENTIAL	0.00	48	48	0.00	48
RESIDENTIAL	0.00	49	49	0.00	49
RESIDENTIAL	0.00	50	50	0.00	50
RESIDENTIAL	0.00	51	51	0.00	51
RESIDENTIAL	0.00	52	52	0.00	52
RESIDENTIAL	0.00	53	53	0.00	53
RESIDENTIAL	0.00	54	54	0.00	54
RESIDENTIAL	0.00	55	55	0.00	55
RESIDENTIAL	0.00	56	56	0.00	56
RESIDENTIAL	0.00	57	57	0.00	57
RESIDENTIAL	0.00	58	58	0.00	58
RESIDENTIAL	0.00	59	59	0.00	59
RESIDENTIAL	0.00	60	60	0.00	60
RESIDENTIAL	0.00	61	61	0.00	61
RESIDENTIAL	0.00	62	62	0.00	62
RESIDENTIAL	0.00	63	63	0.00	63
RESIDENTIAL	0.00	64	64	0.00	64
RESIDENTIAL	0.00	65	65	0.00	65
RESIDENTIAL	0.00	66	66	0.00	66
RESIDENTIAL	0.00	67	67	0.00	67
RESIDENTIAL	0.00	68	68	0.00	68
RESIDENTIAL	0.00	69	69	0.00	69
RESIDENTIAL	0.00	70	70	0.00	70
RESIDENTIAL	0.00	71	71	0.00	71
RESIDENTIAL	0.00	72	72	0.00	72
RESIDENTIAL	0.00	73	73	0.00	73
RESIDENTIAL	0.00	74	74	0.00	74
RESIDENTIAL	0.00	75	75	0.00	75
RESIDENTIAL	0.00	76	76	0.00	76
RESIDENTIAL	0.00	77	77	0.00	77
RESIDENTIAL	0.00	78	78	0.00	78
RESIDENTIAL	0.00	79	79	0.00	79
RESIDENTIAL	0.00	80	80	0.00	80
RESIDENTIAL	0.00	81	81	0.00	81
RESIDENTIAL	0.00	82	82	0.00	82
RESIDENTIAL	0.00	83	83	0.00	83
RESIDENTIAL	0.00	84	84	0.00	84
RESIDENTIAL	0.00	85	85	0.00	85
RESIDENTIAL	0.00	86	86	0.00	86
RESIDENTIAL	0.00	87	87	0.00	87
RESIDENTIAL	0.00	88	88	0.00	88
RESIDENTIAL	0.00	89	89	0.00	89
RESIDENTIAL	0.00	90	90	0.00	90
RESIDENTIAL	0.00	91	91	0.00	91
RESIDENTIAL	0.00	92	92	0.00	92
RESIDENTIAL	0.00	93	93	0.00	93
RESIDENTIAL	0.00	94	94	0.00	94
RESIDENTIAL	0.00	95	95	0.00	95
RESIDENTIAL	0.00	96	96	0.00	96
RESIDENTIAL	0.00	97	97	0.00	97
RESIDENTIAL	0.00	98	98	0.00	98
RESIDENTIAL	0.00	99	99	0.00	99
RESIDENTIAL	0.00	100	100	0.00	100

BUILDING	COMM.	RESI.	MHADA	SPEC.	LIFT	TENE.	TOTAL FSI AREA
BUILDING-A (WING-A1)	00.00	00.00	00.00	00.00	00.00	00	00.00
BUILDING-A (WING-A2)	00.00	4294.42	00.00	00.00	08.67	27	4294.42
BUILDING-A (WING-A3)	00.00	0468.72	00.00	00.00	08.67	03	0468.72
BUILDING-A (WING-A4)	00.00	0468.72	00.00	00.00	08.67	03	0468.72
BUILDING-A (WING-A5)	00.00	4675.67	00.00	00.00	08.67	30	4675.67
BUILDING-A (WING-A6)	00.00	6185.06	00.00	00.00	08.67	39	6185.06
BUILDING-A (WING-A7)	00.00	6185.06	00.00	00.00	08.67	39	6185.06
BUILDING-A (WING-A8)	00.00	6220.24	00.00	00.00	08.67	47	6220.24
BUILDING-B (WING-B1)	00.00	3660.41	00.00	00.00	09.65	40	3660.41
BUILDING-B (WING-B2)	612.97	00.00	00.00	00.00	09.75	00	612.97
TOTAL	612.97	32157.71	00.00	00.00	80.09	228	32770.68

FORM OF STATEMENT 2 (TO BE PRINTED ON PLAN (SR.NO.-4A))	FORM OF STATEMENT 2 (TO BE PRINTED ON PLAN (SR.NO.-4A))	FORM OF STATEMENT 2 (TO BE PRINTED ON PLAN (SR.NO.-4A))	FORM OF STATEMENT 2 (TO BE PRINTED ON PLAN (SR.NO.-4A))
BUILDING NO. FLOOR NO. TOTAL BUILT UP AREA OF FLOOR AS PER OUTER CONSTRUCTION LINE	BUILDING NO. FLOOR NO. TOTAL BUILT UP AREA OF FLOOR AS PER OUTER CONSTRUCTION LINE	BUILDING NO. FLOOR NO. TOTAL BUILT UP AREA OF FLOOR AS PER OUTER CONSTRUCTION LINE	BUILDING NO. FLOOR NO. TOTAL BUILT UP AREA OF FLOOR AS PER OUTER CONSTRUCTION LINE
BUILDING-A (WING-A1) 01 (1ST FLR) 468.72	BUILDING-A (WING-A1) 01 (1ST FLR) 468.72	BUILDING-A (WING-A1) 01 (1ST FLR) 468.72	BUILDING-A (WING-A1) 01 (1ST FLR) 468.72
BUILDING-A (WING-A1) 02 (2ND FLR) 468.72	BUILDING-A (WING-A1) 02 (2ND FLR) 468.72	BUILDING-A (WING-A1) 02 (2ND FLR) 468.72	BUILDING-A (WING-A1) 02 (2ND FLR) 468.72
BUILDING-A (WING-A1) 03 (3RD FLR) 468.72	BUILDING-A (WING-A1) 03 (3RD FLR) 468.72	BUILDING-A (WING-A1) 03 (3RD FLR) 468.72	BUILDING-A (WING-A1) 03 (3RD FLR) 468.72
BUILDING-A (WING-A1) 04 (4TH FLR) 468.72	BUILDING-A (WING-A1) 04 (4TH FLR) 468.72	BUILDING-A (WING-A1) 04 (4TH FLR) 468.72	BUILDING-A (WING-A1) 04 (4TH FLR) 468.72
BUILDING-A (WING-A1) 05 (5TH FLR) 468.72	BUILDING-A (WING-A1) 05 (5TH FLR) 468.72	BUILDING-A (WING-A1) 05 (5TH FLR) 468.72	BUILDING-A (WING-A1) 05 (5TH FLR) 468.72
BUILDING-A (WING-A1) 06 (6TH FLR) 468.72	BUILDING-A (WING-A1) 06 (6TH FLR) 468.72	BUILDING-A (WING-A1) 06 (6TH FLR) 468.72	BUILDING-A (WING-A1) 06 (6TH FLR) 468.72
BUILDING-A (WING-A1) 07 (7TH FLR) 468.72	BUILDING-A (WING-A1) 07 (7TH FLR) 468.72	BUILDING-A (WING-A1) 07 (7TH FLR) 468.72	BUILDING-A (WING-A1) 07 (7TH FLR) 468.72
BUILDING-A (WING-A1) 08 (8TH FLR) 468.72	BUILDING-A (WING-A1) 08 (8TH FLR) 468.72	BUILDING-A (WING-A1) 08 (8TH FLR) 468.72	BUILDING-A (WING-A1) 08 (8TH FLR) 468.72
BUILDING-A (WING-A1) 09 (9TH FLR) 468.72	BUILDING-A (WING-A1) 09 (9TH FLR) 468.72	BUILDING-A (WING-A1) 09 (9TH FLR) 468.72	BUILDING-A (WING-A1) 09 (9TH FLR) 468.72
BUILDING-A (WING-A1) 10 (10TH FLR) 468.72	BUILDING-A (WING-A1) 10 (10TH FLR) 468.72	BUILDING-A (WING-A1) 10 (10TH FLR) 468.72	BUILDING-A (WING-A1) 10 (10TH FLR) 468.72
BUILDING-A (WING-A1) 11 (11TH FLR) 468.72	BUILDING-A (WING-A1) 11 (11TH FLR) 468.72	BUILDING-A (WING-A1) 11 (11TH FLR) 468.72	BUILDING-A (WING-A1) 11 (11TH FLR) 468.72
BUILDING-A (WING-A1) 12 (12TH FLR) 468.72	BUILDING-A (WING-A1) 12 (12TH FLR) 468.72	BUILDING-A (WING-A1) 12 (12TH FLR) 468.72	BUILDING-A (WING-A1) 12 (12TH FLR) 468.72
BUILDING-A (WING-A1) 13 (13TH FLR) 468.72	BUILDING-A (WING-A1) 13 (13TH FLR) 468.72	BUILDING-A (WING-A1) 13 (13TH FLR) 468.72	BUILDING-A (WING-A1) 13 (13TH FLR) 468.72
TOTAL 4294.42	TOTAL 4294.42	TOTAL 4294.42	TOTAL 4294.42

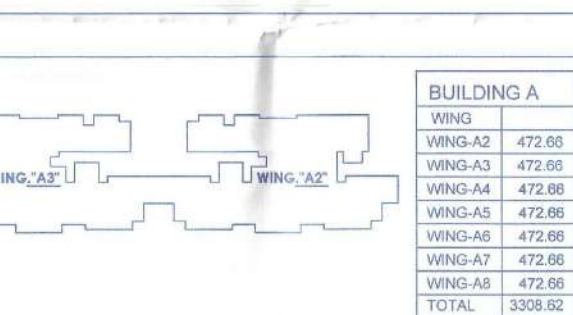
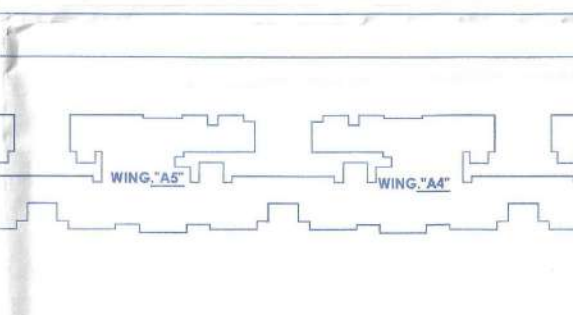
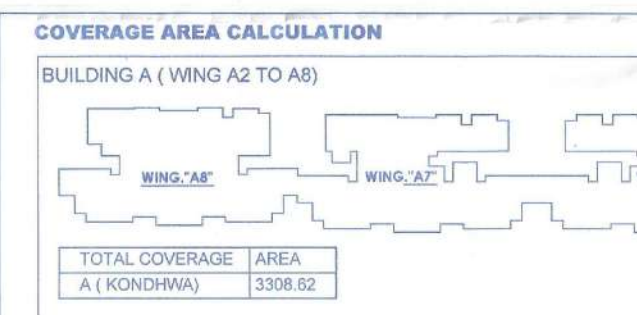
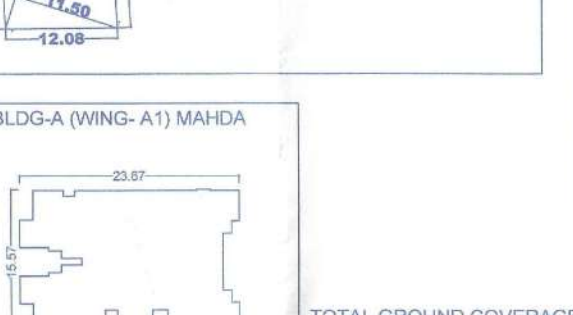
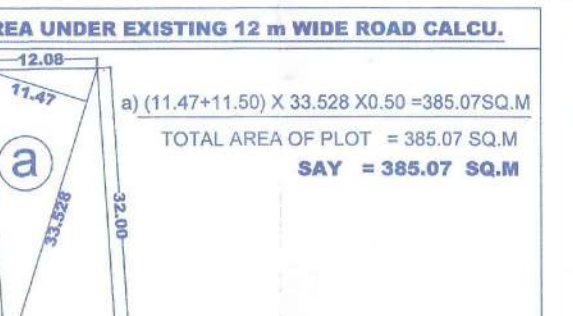
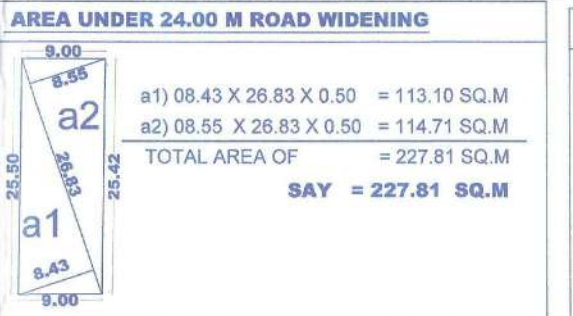
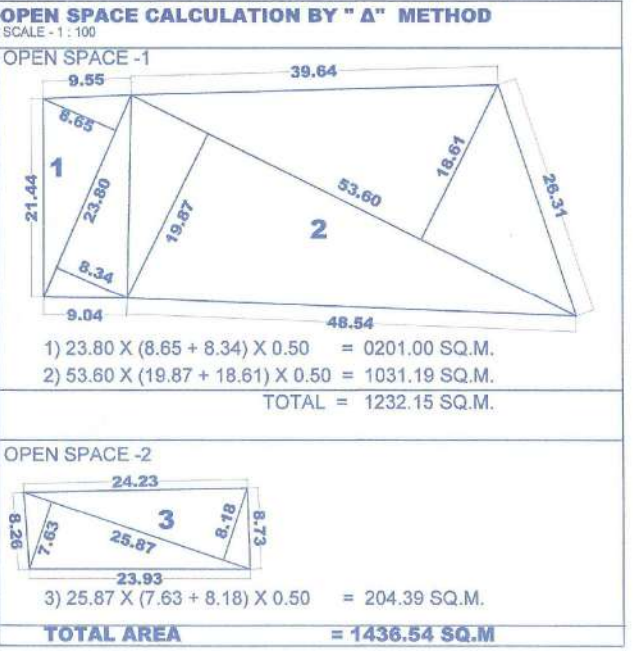

F.S.I. & NON F.S.I. STATEMENT FOR E.C.

BUILDING (A/B)	NO OF FLOOR	HEIGHT	TOTAL F.S.I. AREA	COMM. F.S.I.	RES. F.S.I.	BASEMENT PARKING AREA	BASEMENT PARKING AREA	BASEMENT PARKING AREA	LOW OR PARKING AREA	OPEN SPACE	Q.H.M.T. AREA	LIFT AREA	TOP TERRACE AREA	REFUSE AREA	TOTAL CONSTRUCTION AREA	(BTP W.D.W.T., TRANSFORMER, O.W. CAN)	CLUB HOUSE AREA
BUILDING-A (WING-A1)	PMCH-1+P+10 FLOOR	25.65MT	43	0.00	2944.35	0.00	0.00	0.00	363.57	00.00	37.13	06.54	268.70	0775.34	0.00	0.00	378.79 SQ.M
BUILDING-A (WING-A2)	'B1+B2+P+10 FLOOR'	25.65MT	27	0.00	4294.42	0.00	0.00	0.00	363.57	00.00	37.13	06.54	268.70	0775.34	0.00	0.00	4294.42 SQ.M
BUILDING-A (WING-A3)	'B1+B2+P+10 FLOOR'	25.65MT	27	0.00	4294.42	0.00	0.00	0.00	363.57	00.00	37.13	06.54	268.70	0775.34	0.00	0.00	4294.42 SQ.M
BUILDING-A (WING-A4)	'B1+B2+P+10 FLOOR'	25.65MT	27	0.00	4294.42	0.00	0.00	0.00	363.57	00.00	37.13	06.54	268.70	0775.34	0.00	0.00	4294.42 SQ.M
BUILDING-A (WING-A5)	'B1+B2+P+10 FLOOR'	25.65MT	27	0.00	4294.42	0.00	0.00	0.00	363.57	00.00	37.13	06.54	268.70	0775.34	0.00	0.00	4294.42 SQ.M
BUILDING-A (WING-A6)	'B1+B2+P+10 FLOOR'	25.65MT	27	0.00	4294.42	0.00	0.00	0.00	363.57	00.00	37.13	06.54	268.70	0775.34	0.00	0.00	4294.42 SQ.M
BUILDING-A (WING-A7)	'B1+B2+P+10 FLOOR'	25.65MT	27	0.00	4294.42	0.00	0.00	0.00	363.57	00.00	37.13	06.54	268.70	0775.34	0.00	0.00	4294.42 SQ.M
BUILDING-A (WING-A8)	'B1+B2+P+10 FLOOR'	25.65MT	27	0.00	4294.42	0.00	0.00	0.00	363.57	00.00	37.13	06.54	268.70	0775.34	0.00	0.00	4294.42 SQ.M
BUILDING-B (WING-B1)	PMCH-1+P+10 FLOOR	25.65MT	40	0.00	4172.18	0.00	0.00	0.00	363.57	00.00	37.13	06.54	268.70	0775.34	0.00	0.00	4172.18 SQ.M
BUILDING-B (WING-B2)	'B1+B2+P+10 FLOOR'	25.65MT	27	0.00	4294.42	0.00	0.00	0.00	363.57	00.00	37.13	06.54	268.70	0775.34	0.00	0.00	4294.42 SQ.M
BUILDING-B (WING-B3)	'B1+B2+P+10 FLOOR'	25.65MT	27	0.00	4294.42	0.00	0.00	0.00	363.57	00.00	37.13	06.54	268.70	0775.34	0.00	0.00	4294.42 SQ.M
BUILDING-B (WING-B4)	'B1+B2+P+10 FLOOR'	25.65MT	27	0.00	4294.42	0.00	0.00	0.00	363.57	00.00	37.13	06.54	268.70	0775.34	0.00	0.00	4294.42 SQ.M
BUILDING-B (WING-B5)	'B1+B2+P+10 FLOOR'	25.65MT	27	0.00	4294.42	0.00	0.00	0.00	363.57	00.00	37.13	06.54	268.70	0775.34	0.00	0.00	4294.42 SQ.M
BUILDING-B (WING-B6)	'B1+B2+P+10 FLOOR'	25.65MT	27	0.00	4294.42	0.00	0.00	0.00	363.57	00.00	37.13	06.54	268.70	0775.34	0.00	0.00	4294.42 SQ.M
BUILDING-B (WING-B7)	'B1+B2+P+10 FLOOR'	25.65MT	27	0.00	4294.42	0.00	0.00	0.00	363.57	00.00	37.13	06.54	268.70	0775.34	0.00	0.00	4294.42 SQ.M
BUILDING-B (WING-B8)	'B1+B2+P+10 FLOOR'	25.65MT	27	0.00	4294.42	0.00	0.00	0.00	363.57	00.00	37.13	06.54	268.70	0775.34	0.00	0.00	4294.42 SQ.M
BUILDING-B (WING-B9)	'B1+B2+P+10 FLOOR'	25.65MT	27	0.00	4294.42	0.00	0.00	0.00	363.57	00.00	37.13	06.54	268.70	0775.34	0.00	0.00	4294.42 SQ.M
BUILDING-B (WING-B10)	'B1+B2+P+10 FLOOR'	25.65MT	27	0.00	4294.42	0.00	0.00	0.00	363.57	00.00	37.13	06.54	268.70	0775.34	0.00	0.00	4294.42 SQ.M
BUILDING-B (WING-B11)	'B1+B2+P+10 FLOOR'	25.65MT	27	0.00	4294.42	0.00	0.00	0.00	363.57	00.00	37.13	06.54	268.70	0775.34	0.00	0.00	4294.42 SQ.M
BUILDING-B (WING-B12)	'B1+B2+P+10 FLOOR'	25.65MT	27	0.00	4294.42	0.00	0.00	0.00	363.57	00.00	37.13	06.54	268.70	0775.34	0.00	0.00	4294.42 SQ.M
BUILDING-B (WING-B13)	'B1+B2+P+10 FLOOR'	25.65MT	27	0.00	4294.42	0.00	0.00	0.00	363.57	00.00	37.13	06.54	268.70	0775.34	0.00	0.00	4294.42 SQ.M
BUILDING-B (WING-B14)	'B1+B2+P+10 FLOOR'	25.65MT	27	0.00	4294.42	0.00	0.00	0.00	363.57	00.00	37.13	06.54	268.70	0775.34	0.00	0.00	4294.42 SQ.M
BUILDING-B (WING-B15)	'B1+B2+P+10 FLOOR'	25.65MT	27	0.00	4294.42	0.00	0.00	0.00	363.57	00.00	37.13	06.54	268.70	0775.34	0.00	0.00	4294.42 SQ.M
BUILDING-B (WING-B16)	'B1+B2+P+10 FLOOR'	25.65MT	27	0.00	4294.42	0.00	0.00	0.00	363.57	00.00	37.13	06.54	268.70	0775.34	0.00	0.00	4294.42 SQ.M
BUILDING-B (WING-B17)	'B1+B2+P+10 FLOOR'	25.65MT	27	0.00	4294.42	0.00	0.00	0.00	363.57	00.00	37.13	06.54	268.70	0775.34	0.00	0.00	4294.42 SQ.M
BUILDING-B (WING-B18)	'B1+B2+P+10 FLOOR'	25.65MT	27	0.00	4294.42	0.00	0.00	0.00	363.57	00.00	37.13	06.54	268.70	0775.34	0.00	0.00	4294.42 SQ.M
BUILDING-B (WING-B19)	'B1+B2+P+10 FLOOR'	25.65MT	27	0.00	4294.42	0.00	0.00	0.00	363.57	00.00	37.13	06.54	268.70	0775.34	0.00	0.00	4294.42 SQ.M
BUILDING-B (WING-B20)	'B1+B2+P+10 FLOOR'	25.65MT	27	0.00	4294.42	0.00	0.00	0.00	363.57	00.00	37.13	06.54	268.70	0775.34	0.00	0.00	4294.42 SQ.M
BUILDING-B (WING-B21)	'B1+B2+P+10 FLOOR'	25.65MT	27	0.00	4294.42	0.00	0.00	0.00	363.57	00.00	37.13	06.54	268.70	0775.34	0.00	0.00	4294.42 SQ.M
BUILDING-B (WING-B22)	'B1+B2+P+10 FLOOR'	25.65MT	27	0.00	4294.42	0.00	0.00	0.00	363.57	00.00	37.13	06.54	268.70	0775.34	0.00	0.00	4294.42 SQ.M
BUILDING-B (WING-B23)	'B1+B2+P+10 FLOOR'	25.65MT	27	0.00	4294.42	0.00	0.00	0.00	363.57	00.00	37.13	06.54	268.70	0775.34	0.00	0.00	4294.42 SQ.M
BUILDING-B (WING-B24)	'B1+B2+P+10 FLOOR'	25.65MT	27	0.00	4294.42	0.00	0.00	0.00	363.57	00.00	37.13	06.54	268.70	0775.34	0.00	0.00	4294.42 SQ.M
BUILDING-B (WING-B25)	'B1+B2+P+10 FLOOR'	25.65MT	27	0.00	4294.42	0.00	0.00	0.00	363.57	00.00	37.13	06.54	268.70	0775.34	0.00	0.00	4294.42 SQ.M
BUILDING-B (WING-B26)	'B1+B2+P+10 FLOOR'	25.65MT	27	0.00	4294.42	0.00	0.00	0.00	363.57	00.00	37.13	06.54	268.70	0775.34	0.00	0.00	4294.42 SQ.M
BUILDING-B (WING-B27)	'B1+B2+P+10 FLOOR'	25.65MT	27	0.00	4294.42	0.00	0.00	0.00	363.57	00.00	37.13	06.54	268.70	0775.34	0.00	0.00	4294.42 SQ.M
BUILDING-B (WING-B28)	'B1+B2+P+10 FLOOR'	25.65MT	27	0.00	4294.42	0.00	0.00	0.00	363.57	00.00	37.13	06.54	268.70	0775.34	0.00	0.00	4294.42 SQ.M
BUILDING-B (WING-B29)	'B1+B2+P+10 FLOOR'	25.65MT	27	0.00	4294.42	0.00	0.00	0.00	363.57	00.00	37.13	06.54	268.70	0775.34	0.00	0.00	4294.42 SQ.M
BUILDING-B (WING-B30)	'B1+B2+P+10 FLOOR'	25.65MT	27	0.00	4294.42	0.00	0.00	0.00	363.57	00.00	37.13	06.54	268.70	0775.34	0.00	0.00	4294.42 SQ.M
BUILDING-B (WING-B31)	'B1+B2+P+10 FLOOR'	25.65MT	27	0.00	4294.42	0.00	0.00	0.00	363.57	00.00	37.13	06.54	268.70	0775.34	0.00	0.00	4294.42 SQ.M
BUILDING-B (WING-B32)	'B1+B2+P+10 FLOOR'	25.65MT	27	0.00	4294.42	0.00	0.00	0.00	363.57	00.00	37.13	06.54	268.70	0775.34	0.00	0.00	4294.42 SQ.M
BUILDING-B (WING-B33)	'B1+B2+P+10 FLOOR'	25.65MT	27	0.00	4294.42	0.00	0.00	0.00	363.57	00.00	37.13	06.54	268.70	0775.34	0.00	0.00	4294.42 SQ.M
BUILDING-B (WING-B34)	'B1+B2+P+10 FLOOR'	25.65MT	27	0.00	4294.42	0.00	0.00	0.00	363.57	00.00	37.13	06.54	268.70	0775.34	0.00	0.00	4294.42 SQ.M
BUILDING-B (WING-B35)	'B1+B2+P+10 FLOOR'	25.65MT	27	0.00	4294.42	0.00	0.00	0.00	363.57	00.00	37.13	06.54	268.70	0775.34	0.00	0.00	4294.42 SQ.M
BUILDING-B (WING-B36)	'B1+B2+P+10 FLOOR'	25.65MT	27	0.00	4294.42	0.00	0.00	0.00	363.57	00.00	37.13	06.54	268.70	0775.34	0.00	0.00	4294.42 SQ.M
BUILDING-B (WING-B37)	'B1+B2+P+10 FLOOR'	25.65MT	27	0.00	4294.42	0.00	0.00	0.00	363.57	00.00	37.13	06.54	268.70	0775.34	0.00	0.00	4294.42 SQ.M
BUILDING-B (WING-B38)	'B1+B2+P+10 FLOOR'	25.65MT	27	0.00	4294.42	0.00	0.00	0.00	363.57	00.00	37.13	06.54	268.70	0775.34	0.00	0.00	4294.42 SQ.M
BUILDING-B (WING-B39)	'B1+B2+P+10 FLOOR'	25.65MT	27	0.00	4294.42	0.00	0.00	0.00	363.57	00.00	37.13	06.54	268.70	0775.34	0.00	0.00	4294.42 SQ.M
BUILDING-B (WING-B40)	'B1+B2+P+10 FLOOR'	25.65MT	27	0.00	4294.42	0.00	0.00	0.00	363.57	00.00	37.13	06.54	268.70	0775.34	0.00	0.00	4294.42 SQ.M
BUILDING-B (WING-B41)	'B1+B2+P+10 FLOOR'	25.65MT	27	0.00	4294.42	0.00	0.00	0.00	363.57	00.00	37.13	06.54	268.70	0775.34	0.00	0.00	4294.42 SQ.M
BUILDING-B (WING-B42)	'B1+B2+P+10 FLOOR'	25.65MT	27	0.00	4294.42	0.00	0.00	0.00	363.57	00.00	37.13	06.54	268.70	0775.34	0.00	0.00	4294.42 SQ.M
BUILDING-B (WING-B43)	'B1+B2+P+10 FLOOR'	25.65MT	27	0.00	4294.42	0.00	0.00	0.00	363.57	00.00	37.13	06.54	268.70	0775.34	0.00	0.00	4294.42 SQ.M
BUILDING-B (WING-B44)	'B1+B2+P+10 FLOOR'	25.65MT	27	0.00	4294.42	0.00	0.00	0.00	363.57	00.00	37.13	06.54	268.70	0775.34	0.00	0.00	4294.42 SQ.M
BUILDING-B (WING-B45)	'B1+B2+P+10 FLOOR'	25.65MT	27	0.00	4294.42	0.00	0.00	0.00	363.57	00.00	37.13	06.54	268.70	0775.34	0.00	0.00	4294.42 SQ.M
BUILDING-B (WING-B46)	'B1+B2+P+10 FLOOR'	25.65MT	27	0.00	4294.42	0.00	0.00	0.00	363.57	00.00	37.13	06.54	268.70	0775.34	0.00	0.00	4294.42 SQ.M
BUILDING-B (WING-B47)	'B1+B2+P+10 FLOOR'	25.65MT	27	0.00	4294.42	0.00	0.00	0.00	363.57	00.00	37.13	06.54	268.70	0775.34	0.00	0.00	4294.42 SQ.M
BUILDING-B (WING-B48)	'B1+B2+P+10 FLOOR'	25.65MT	27	0.00	4294.42	0.00	0.00	0.00	363.57	00.00	37.13	06.54	268.70	0775.34	0.00	0.00	4294.42 SQ.M
BUILDING-B (WING-B49)	'B1+B2+P+10 FLOOR'	25.65MT	27	0.00	4294.42	0.00	0.00	0.00	363.57	00.00	37.13	06.54	268.70	0775.34	0.00	0.00	4294.42 SQ.M
BUILDING-B (WING-B50)	'B1+B2+P+10 FLOOR'	25.65MT	27	0.00	4294.42	0.00	0.00	0.00	363.57	00.00	37.13	06.54	268.70	0775.34	0.00	0.00	4294.42 SQ.M
BUILDING-B (WING-B51)	'B1+B2+P+10 FLOOR'	25.65MT	27	0.00	4294.42	0.00	0.00	0.00	363.57	00.00	37.13	06.54	268.70	0775.34	0.00	0.00	4294.42 SQ.M
BUILDING-B (WING-B52)	'B1+B2+P+10 FLOOR'	25.65MT	27	0.00	4294.42	0.00	0.00	0.00	363.57	00.00	37.13	06.54	268.70	0775.34	0.00	0.00	4294.42 SQ.M
BUILDING-B (WING-B53)	'B1+B2+P+10 FLOOR'	25.65MT	27	0.00	4294.42	0.00	0.00	0.00	363.57	00.00	37.13	06.54	268.70	0775.34	0.00	0.00	4294.42 SQ.M
BUILDING-B (WING-B54)	'B1+B2+P+10 FLOOR'	25.65MT	27	0.00	4294.42	0.00	0.00	0.00	363.57	00.00	37.13	06.54	268.70	0775.34	0.00	0.00	4294.42 SQ.M
BUILDING-B (WING-B55)	'B1+B2+P+10 FLOOR'	25.65MT	27	0.00	4294.42												